

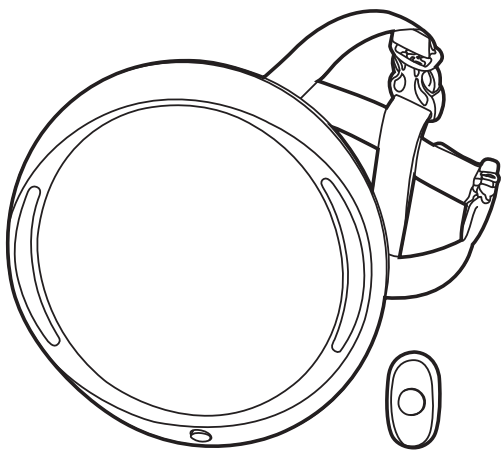

IRIS BABY MIRROR DELUXE



**IMPORTANT! ADULT ASSEMBLY REQUIRED!
PLEASE READ THESE INSTRUCTIONS CAREFULLY
AND KEEP THEM FOR FUTURE REFERENCE!**

COMPONENT LIST

- A** LIGHT
- B** BUTTON
- C** RIBBON
- D** BUCKLE
- E** ADJUSTMENT GEAR LOCK
- F** PIVOT PIN
- G** BATTERY COMPARTMENT
- H** VERTICAL BUCKLE
- I** BASE BACK PLATE
- J** ADJUSTABLE STAND
- K** CLIP
- L** REMOTE CONTROL BUTTON
- M** REMOTE BATTERY COMPARTMENT

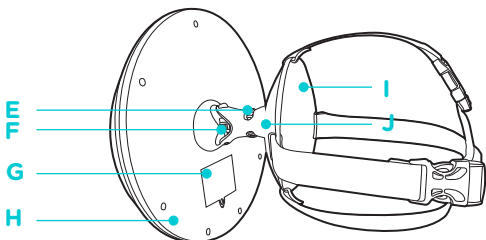
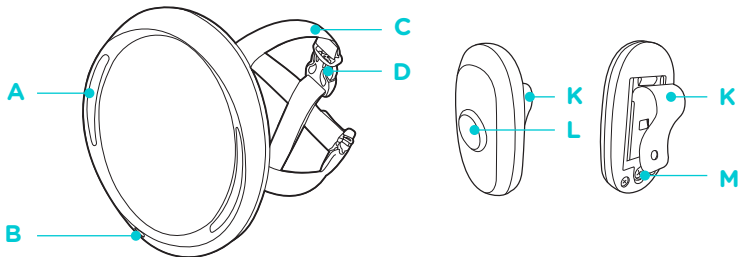

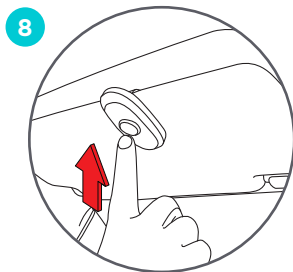
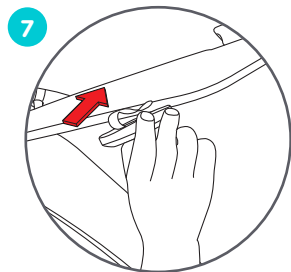
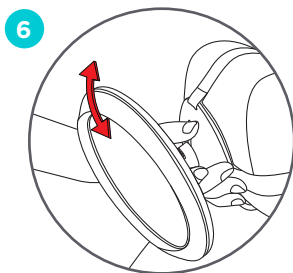
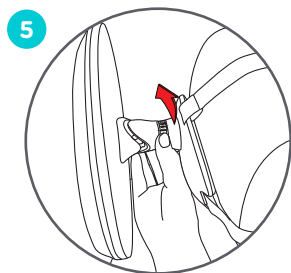
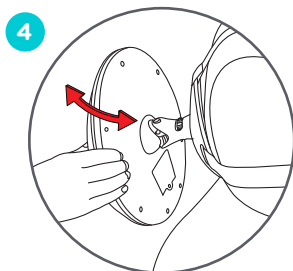
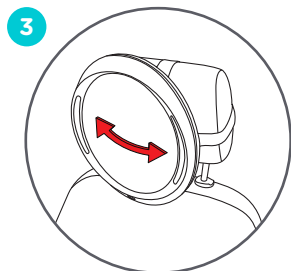
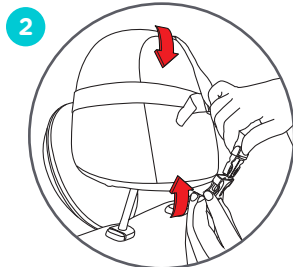
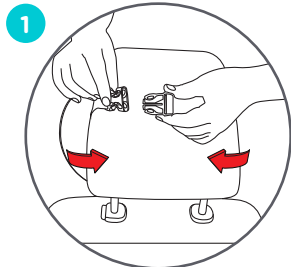

INSTRUCTION

INSTALLATION

- Fasten lateral buckle(D), put the mirror to the head restraint. (fig. 1)
- Raise the head restraint.
- Insert the lower ribbon underneath head restraint, fasten vertical buckle (D). (fig. 2)
- Reset the head restraint, adjust ribbon to make sure the mirror fixed in a stable position.
- Once in a fixed position, the mirror can be adjusted to show your baby. (fig. 3, 4)
- Once in correct position, tighten the adjustment gear lock (E). (fig. 5, 6)

Caution: Gear(E) must be locked tight to avoid shaking during driving.

- Insert the remote with the sunshade plate. (fig. 7)
- Make sure the remote is in the range of your reach.

Caution: Make sure the remote is clipped tight with the sunshade plate. The remote may drop down due to loose fit, it may cause injury.

- Press the button to turn on / turn off the light.(fig. 8)

Caution: For the sake of protecting baby's and your eyes, our light is dimmable. When you press the on / off button, you need wait 1-2 seconds, then the light will become brighter or darker gradually.

 **W A R N I N G !**

CARELESSNESS CAUSES FIRE.

THE PRODUCT HAS BEEN TESTED ACCORDING TO THE RELEVANT SAFETY STANDARDS.

DO NOT GIVE THIS PRODUCT TO CHILDREN TO PLAY WITH. WHEN NOT IN USE, KEEP IT OUT OF CHILDREN'S REACH.



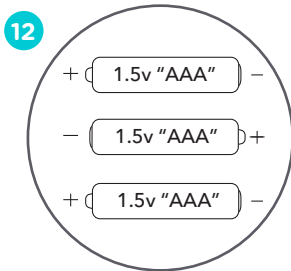
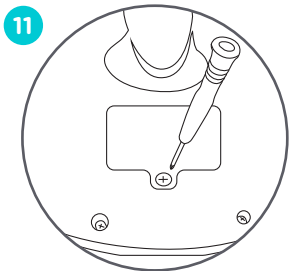
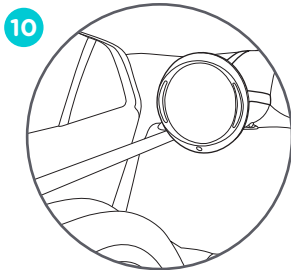
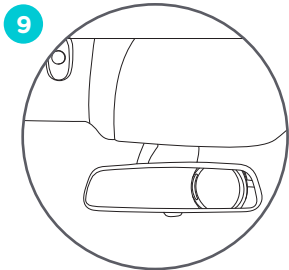

HOW TO USE

- Driver can observe baby from the rear view mirror . (fig. 9, 10)
- When it's dark in the car, push the remote button (L) to turn on the mirror light, or manual control by pushing button(B) to turn on the light.

BATTERY INSTALLATION

- Loosen the screw in the battery compartment door with a screwdriver, remove the battery compartment door. (fig. 11)
- Insert three(3) "AAA" batteries. (fig. 12)
- Replace the battery compartment door and tighten the screw with a screwdriver.

Caution: The remote has already installed one button cell.

When the battery power is low, will affect the brightness of the light & the remote control. Please replace with new batteries.

APRAMO UK LTD
UNITS 46-48,
DRAYTON MANOR BUSINESS PARK,
COLESHILL ROAD, TAMWORTH,
B78 3TL
www.apramo.com

